

**Section Showing Typical Arrangement of Truss Between Grid J To L in side projection**

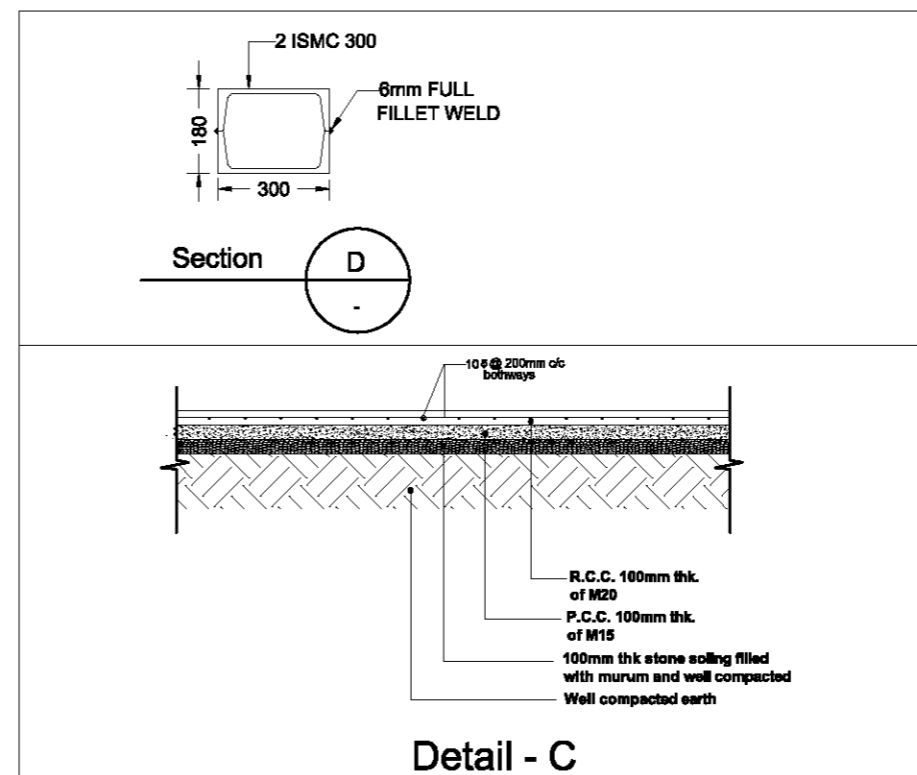

**Detail - C**

**SCHEDULE OF MEMBER**

①	Rafter size	- Pipe OD 127H (5.4mm Thk.)
②	Strut Member	- Pipe OD 76.1 L (3.2mm Thk.)
③	Tie Member Size	- Pipe OD 127 H (5.4mm Thk.)
④	Purlin Size	- 2 x 101.6 OD (3.8mm Thk.)
⑤	Tie Beam	- 2 ISMC-300 BOX (Double)
⑥	Truss Column	- 2 ISMC-300 BOX (Double)
R1		101.6L OD (3.8mm Thk.)

**Notes**

1. All dimensions are in mm & levels are in mt.
2. All bolt shall confirm to IS 1364-1967 of M-8.8 grade.
3. All weld to be 6mm full fillet weld unless specified otherwise.
4. All welding shall confirm to IS 2062.
5. Holes wherever required shall be made by drilling & gas cutting shall not be allowed.
6. I.S. indicates indian standard.

R0	23-03-2015	L.L	DPR	R.T.G	S.K.S
Rev	Date	Drawn	Description	Ch'k'd	App'd



2nd Floor, Bellevue Mansion  
Opposite Clinic Research Unit  
(Tribal) for Homoeopathy  
Malik-Dhankhet  
Shillong -793001  
Meghalaya, India  
T +91 (0) 364 2505 446  
F  
W www.mottmac.com

Client  
**State Investment Program Management and Implementation Unit (SIPMIU)**  
Government of Meghalaya

Title  
**North Eastern Region Capital Cities Development Investment Programme for Shillong, Solid Waste Management Section Showing Typical Arrangement of Truss Grid Between J To L**

Drawn	L.L	Eng check	P.A.J
Dwg check	R.T.G		
Approved	S.K.S		
Scale at A3	Status	Rev	
Nts	DPR	R0	
Drawing Number	MMD-260652-S-DR-SWM-00-1009		