

# LAYOUT PLAN OF COMPOST PLANT AT MARTEN

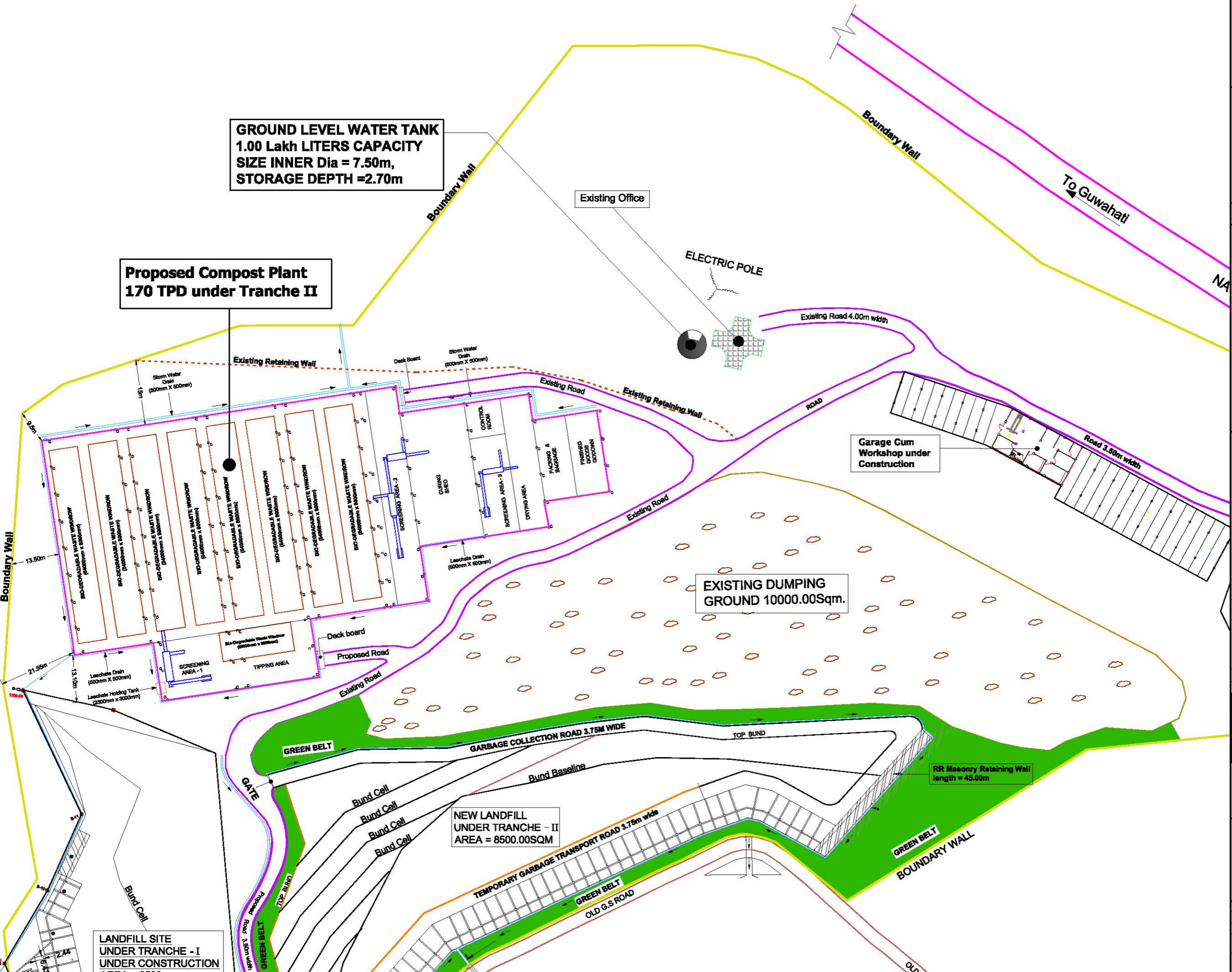

**GROUND LEVEL WATER TANK**  
 1.00 Lakh LITERS CAPACITY  
 SIZE INNER Dia = 7.50m,  
 STORAGE DEPTH = 2.70m

**Proposed Compost Plant**  
 170 TPD under Tranche II



**LEGENDS**

BOUNDARY WALL	
PROPOSED ROAD	
EXISTING ROAD	
DRAIN	
COMPOST PLANT	
COLUMN	

Rev	Date	Drawn	Description	Ch'kd	App'd
RD	20/03/16	LL	Detail Project Report	R.T.G	S.K.S

**Mott MacDonald**

2nd Floor, De Borens Building  
 Opposite Civil Research Unit  
 (TIFR) for Housenpurdy  
 Main: Guwahati  
 Dist: Assam  
 Pin: 781001  
 Meghalaya, India  
 T: +91 (9) 364 2025 446  
 F: +91 (9) 364 2025 446  
 W: www.mottmac.com

Client: **State Investment Program Management and Implementation Unit (SIPMIU) Government of Meghalaya**

Title: **North Eastern Region Capital Cities Development Investment Programme For Shillong, Solid Waste Management Layout Plan Of Compost Plant at Marten**

Drawn	LLyngdoh	Eng check	P.A.J
Diag check	R.T.G		
Approved	S.K.S		
Scale at AS	1:1000	Status	DPR
Rev	RD		
Drawing Number	<b>MMD-260652-C-DR-00-SWM-1003</b>		